



**BELGRADE  
FAIR**

FURNITURE FAIR DEPARTMENT  
Bulevar vojvode Misica 14, 11000 Belgrade, Serbia  
Tel: +381 11 2655 231, 2655 831, 2655 919  
namestaj@sajam.rs  
sajamnamestaja.rs

59<sup>th</sup>

**International Fair  
of Furniture, Equipment  
and Interior Decoration**

**October 6-11, 2023**

59<sup>th</sup>

**Belgrade  
Furniture  
Fair 2023  
Now**



**1**

**Application Form for Participation**

**Space Allocation from  
May 31st, 2023**

The present Application form should be filled and certified in 3 copies. All copies should be submitted to Belgrade Fair which will confirm the receipt and return a copy to the Exhibitor

To be filled in block letters

Full name of Exhibitor:

Address: country, town

Street and number, P.O.B.

Phone:

Tel/Mob:

E-mail:

http:

Agent in Serbia  
(name, address & phone):

All correspondencies to be addressed to:

All contact should be made through:

Payment affected to the bank account number:

**We rent**

1. Indoor space	appr. <input type="text"/> sq.m.	70,- € /sq.m.
2. Stand package Standard, Application form 3 (the price includes the space and stand construction)	appr. <input type="text"/> sq.m.	98,- € /sq.m.
3. Stand package Lux, Application form 3a (the price includes the space and stand construction)	appr. <input type="text"/> sq.m.	110,- € /sq.m.
4. Outdoor space	appr. <input type="text"/> sq.m.	45,- € /sq.m.

**Registration Fee**

Exhibitors € 300,-

Co-Exhibitors € 240,-

Co-exhibitors are requested to fill in the separate Application form for the participation.

Payment upon receipt of the proforma invoice.  
The prices are mentioned in NET amounts.  
An VAT shall be added to them.

Please, send also the completely filled in Application for Compulsory Registration in the Official Exhibitor Register and the USB along with the present Application.

The allowed height of the stand partition wall structure is 4.0 m at the indoor exhibiting space, except in designer halls. The maximal component height for which the compensation shall not be paid is 4.0 m.

We declare hereby that we are aware of the participation conditions mentioned in the General Rules for Participation at Belgrade Fair Events and the present Application Form and that we fully accept them.

Payment upon receipt of the proforma invoice.

TO BE FILLED IN BY BELGRADE FAIR

Confirmed acceptance  
of Application form

File No.

Location

Venue and date

Seal

Exhibitors signature

Date-Signature-Seal

## **EXHIBITORS**

Companies or individuals renting exhibition space for their product range display are entitled to the registration in the official Fair Catalogue, inscription on fascia panel and the right to use all other Belgrade Fair services.

## **CO-EXHIBITORS**

If the stand area rented by the Exhibitor is used by another company represented by its own exhibits and staff, such company shall apply as Co-Exhibitor and shall submit a separate Application form and pay the Registration fee for compulsory Catalogue listing.

Co-Exhibitors shall have their inscription on the fascia panel alongside Exhibitor's inscription.

The Exhibitor has the right to install inscriptions of Co-Exhibitors as stated above on his own stand only if he applied for such Co-Exhibitors to Belgrade Fair.

If the Exhibitor does not apply for Co-Exhibitors or submit incomplete data in its Application form, Belgrade Fair has the right to charge the Exhibitor for all the costs related to Registration fees for Co-Exhibitors.

- The Fair shall submit to the Exhibitors the forms for use of electrical power, water, telephone, car parking, to be filled in and returned to Belgrade Fair by the stipulated date. Otherwise, Belgrade Fair shall not provide the Exhibitor with the services stated above. The services are charged according to the Belgrade Fair Price List, based on the supplied services confirmation as stated in this Application form.

- If the stand construction is carried out by the Exhibitor himself he is obligated to pay all joint expenses as stated in the Belgrade Fair Price List.

- Exhibitors shall obey the opening and closing dates of the Fair event and particularly shall arrange for their stand with the exhibits to be open by the closing date of the Fair event.

- In case the Exhibitor does not act in accordance with the previous item, which shall be stated in writing by the Hall Supervisor, the Exhibitor shall pay the Contract penalty of EUR 1.000,-

**The deadline for submitting Application forms is May 31, 2023.**

The advantage in space location is given to the last year's exhibitors, if their Application is submitted before the above indicated deadline.

**After the deadline has expired, the booking of exhibition space is no longer guaranteed by the Fair.**

## **REGISTRATION FEE INCLUDES**

- Publishing Exhibitor's data (complete business address, telephone, fax, E-mail, http and representation office address) in the official Fair Catalogue.

- Publishing up to 20 words of text describing Exhibitor's product range or activity in the Fair Catalogue.

- Publishing of Exhibitor's registered trade mark.

- A Complimentary copy of the Catalogue.

- Exhibitor cards - 4 cards for the rent of up to 50sqm, 2 cards for each additional 50sqm of rented space (not more than 10 cards).

- Exhibitors are entitled to 2 parking cards for the rent of 50 sqm, and another parking cards for each additional 50 sqm, but not more than 5.

## **REGISTRATION FEE FOR CO-EXHIBITORS INCLUDES**

- Publishing Co-Exhibitor's data (complete business address, telephone, fax, e-mail, http and representative office address) in the Official Catalogue and/or USB and/or B2B portal.

- Publishing up to 20 words of text describing Co-Exhibitor's product range or activity in the Fair Catalogue.

- Publishing of Co-Exhibitor's registered trademark.

- A complementary copy of the Catalogue.

- 1 Exhibitor card for each officially registered Co-Exhibitor.

- 1 Parking lot pass for each Co-Exhibitor vehicle officially registered.

Note: Exhibitors and Co-exhibitors may purchase additional complimentary official passes and parking lot passes.

- The official Catalogue is printed in Serbian and English. Exhibitors are responsible for the accuracy of the data given. The Catalogue Editorial Staff reserves the right to adjust the titles of the products stated in this Application to those contained in the Catalogue nomenclature.

## **INSURANCE**

- Exhibits and other Exhibitor's property shall be covered by insurance policy at all Belgrade Fair exhibitions through domestic or foreign insurance company in the country or abroad.

- Any responsibility for a damage to the exhibits and/or any other Exhibitor's property, if such exhibits and/or property are not insured in a way stipulated by the previous item, shall be completely borne by the Exhibitor.

## **PAYMENT**

Exhibitors shall effect the payment through the Bank stipulated in the pro-forma invoice. Each Contract Party shall bear the bank charges in its own country. Exhibitors are requested to fulfil following liabilities:

- Exhibitor is liable to pay 20% of the invoiced amount for the rented exhibition space allocated and confirmed by Belgrade Fair and stand construction, as the confirmation of the reserved allocated exhibition space immediately upon the receipt of pro-forma invoice or invoice, not later than 30 days prior to the beginning of the Fair event.

In case the Exhibitor has applied and the Fair allocates and confirms the exhibition space in the period less than 30 days prior to the beginning of the Fair event, Exhibitor is liable to pay for the services rendered immediately upon the receipt of the pro-forma invoice or invoice.

- For other requirements not later than 15 days after the closing date of the Fair event by invoice to the Fair foreign currency account at an authorized commercial bank.

In case of payment after a contract date, the exhibitor shall pay an interest rate according to the rate of the National bank of Serbia at the moment of settlement the due amount.

Exhibitors may withdraw the submitted Application form 15 days upon the application registration.

In case the Exhibitor withdraws the Application form after the issue of the Application form confirmation, the Exhibitor will be liable for 100% of the total cost for space, Registration fee and other expenses due to the Exhibitor's cancellation.

## **AWARDING**

Traditional award is awarded at the International Furniture Fair, **The Golden Key**, in accordance with the Rules of Prize Awarding at the International Furniture Fair. Official exhibit applying for the estimation is carried out by the Application Form for Participation (Form 1). All displayed exhibits are in the competition. The exhibit selection and the awarding decisions are taken by an International Professional Jury.

**Application form has the legal force of a Contract. In case of any disputes, the Contract Parties have agreed to settle such disputes by the Foreign Trade Arbitration with the Serbian Chamber of Commerce in Belgrade.**

**Regulations for Participation at Belgrade Fair Events shall be a form part of the Contract.**

### HALL 3

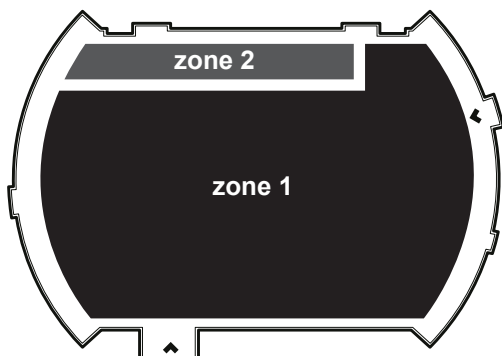

#### Zone 1

1. Mandatory free-standing lights (central lighting in the hall is not used)
2. Wall height 2.8m
3. Mandatory trusses (minimum 4 m in height)
4. Mandatory raised floor (formation of maintenance shafts for connection points)
5. Walls made of solid material (chipboard)

#### Zone 2

1. Mandatory free-standing lights (central lighting in the hall is not used)
2. Wall height 2.8m
3. Mandatory raised floor (formation of maintenance shafts for connection points)
4. Walls made of solid material (either chipboard or mortar)

### HALL 3A

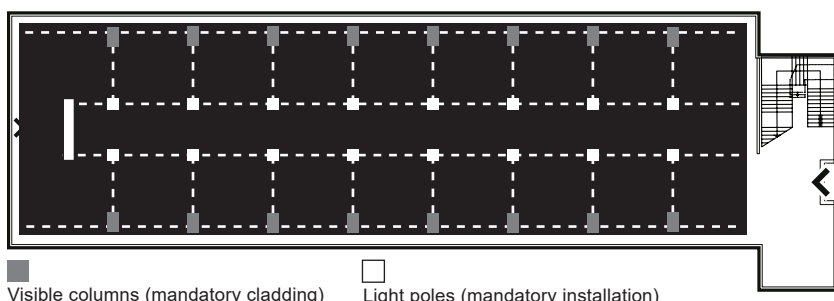

1. Mandatory free-standing lights (central lighting in the hall is not used)
2. Wall height 2.8m
3. Walls made of solid material (chipboard)
4. Obligatory cladding of visible columns (cladding dimensions 60x60cm, height 2.8m) - Formation of maintenance shafts for connection points
5. Mandatory installation of light poles, 2.8 m in height, 60x60 cm wide
6. Walls and columns made of solid material painted in the same color; color to be defined by the Organizer
7. Mandatory laying of wall-to-wall carpets across the entire hall surface in the color defined by the Organizer
8. Mandatory use of wood black beams (lighting system supports), 10x12 cm in size

### HALL 2B

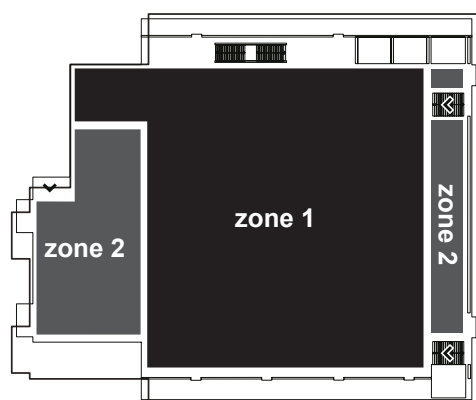

#### Zone 1

1. Mandatory free-standing lights (central lighting in the hall is not used)
2. Wall height 2.8m
3. Mandatory raised floor (formation of maintenance shafts for connection points)
4. Walls made of solid material (chipboard)
5. Mandatory cladding of visible columns (cladding dimensions 60x60cm, height 2.8m) - Formation of maintenance shafts for connection points
6. Mandatory use of wood black beams (lighting system supports), 10x12 cm in size

#### Zone 2

1. Mandatory free-standing lights (central lighting in the hall is not used)
2. Wall height 2.8m
3. Mandatory raised floor (formation of maintenance shafts for connection points)
4. Walls made of solid material (either chipboard or mortar)
5. Obligatory cladding of visible columns (cladding dimensions 60x60cm, height 2.8m) - Formation of maintenance shafts for connection points
6. Mandatory installation of light poles - 2.8m in height, 40x40cm wide

### HALL 2C

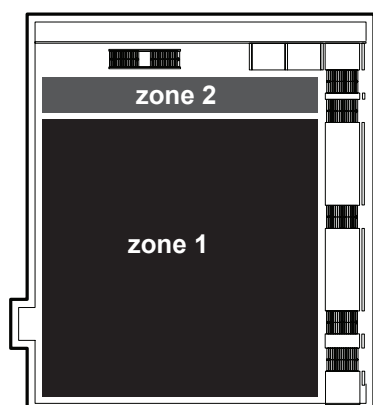

#### Zone 1

1. Mandatory free-standing lights (central lighting in the hall is not used)
2. Wall height 2.8m
3. Mandatory trusses
4. Mandatory raised floor (formation of maintenance shafts for connection points)
5. Walls made of solid material (chipboard)

#### Zone 2

1. Mandatory free-standing lights (central lighting in the hall is not used)
2. Wall height 2.8m
3. Mandatory raised floor (formation of maintenance shafts for connection points)
4. Walls made of solid material (either chipboard or mortar)

## HALL 2A

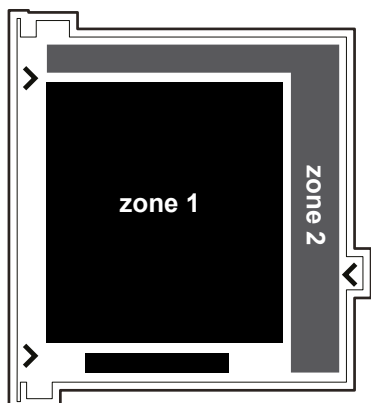

### Zone 1

1. Maximum height of stand inside elements for which compensation is not paid totals 4 m
2. Maximum permitted height 6m

### Zone 2

1. Maximum height of stand inside elements for which compensation is not paid totals 4 m
2. Maximum permitted height 5.5m

## HALL 1A

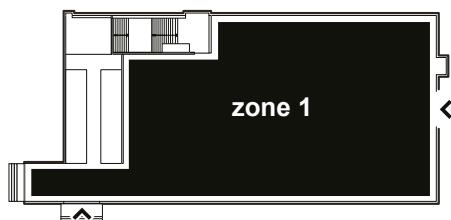

Maximum element height 2.5m

## HALL 1

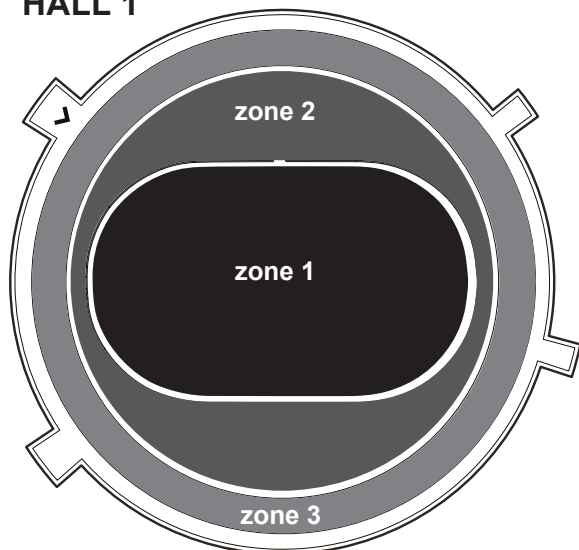

### Zone 1

1. Maximum height of stand inside elements for which compensation is not paid totals 4 m
2. Maximum permitted height 6m
3. Building is not allowed in standard construction

### Zone 2

1. Maximum height of stand inside elements for which compensation is not paid totals 4 m
2. Maximum permitted height 6m

### Zone 3

Maximum permitted height of the interior stand elements 3.8m

## HALL 4

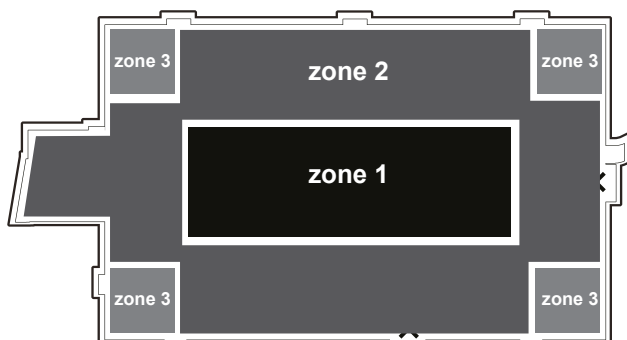

### Zone 1

1. Maximum height of exhibition stand inside elements for which compensation is not paid totals 4m
2. Maximum permitted height 6m

### Zone 2

Maximum permitted height of the interior stand elements 3.8m

### Zone 3

Maximum permitted height of the interior stand elements 3.5m



**BELGRADE  
FAIR**

FURNITURE FAIR DEPARTMENT  
Bulevar vojvode Misica 14, 11000 Belgrade, Serbia  
Tel: +381 11 2655 231, 2655 831, 2655 919, 2655 849  
namestaj@sajam.rs  
sajamnamestaja.rs

59<sup>th</sup>

**International Fair  
of Furniture, Equipment  
and Interior Decoration**

**October 6-11, 2023**

59<sup>th</sup>

**Belgrade  
Furniture  
Fair 2023  
Now**



**2**

**Application Form for Compulsory Registration  
in Official Fair Catalogue & CD-rom**

Present Application form should be filled in and certified in three copies. All copies should be submitted to Belgrade Fair which will confirm the receipt and return a copy to the Exhibitor.

Please state the Alphabet letter under which to be registered in the Official Fair Catalogue

To be filled in block letters

**Full name of Exhibitor:**

**Address:  
country, zip code and town:**

**Street and number, P.O.B:**

**Telefon:**

**Tel/Mob:**

**E-mail:**

**http:**

**Agent in Serbia  
(name, address and phone):**

**Activity wording:**

---

---

---

---

---

---

---

---

---

---

**With copies of application please enclose (by e-mail):**

1. For publishing in the Fair Catalogue and USB - your registered trade mark (.tiff .eps .png .pdf ili .jpg format - at least 600 px width)
2. For publishing on the USB - 5 chosen photos (.tiff .eps .png ili .jpg format - at least 1200 px width)

**Compulsory registration fee as per Application for Participation amounts to EUR 300.**

Publishing in the Fair Catalogue of data about activities not exceeding 20 words, and the registered trade mark are included in the registration fee. Each additional word shall be charged EUR 4. The registration fee amount includes also publishing of 5 (five) photos at USB.

The prices are mentioned in NET amounts. VAT shall be added to them.

**Commodity group(s) you belong to (please tick) :**

- **HOME FURNITURE**
  - ROOMS
    - LIVING ROOMS
      - Upholstered furniture (seating furniture, armchairs, sofas)
      - Piece furniture (tables, table sets, wardrobes, closets, glass cabinets, shelves)
    - BEDROOMS
      - Beds
      - Mattresses and foot of beds
      - Wardrobes, closets, chests, bedside cabinets, shelves...
    - NURSERIES
      - Beds
      - Wardrobes, shelves, tables and chairs
      - Playmate furniture
    - ENTRANCE HALLS
      - Wardrobes, coat racks, shoe chests...
    - DINING ROOMS
      - Tables and chairs
      - Glass cabinets, chests, shelves...
    - KITCHENS
      - Kitchen units
      - Sinks
      - Household appliances
    - BATHROOMS
      - Bathroom furniture and equipment
  - **FURNITURE FOR PUBLIC FACILITIES**
    - OFFICE FURNITURE
    - HOTEL FACILITIES AND CATERING FURNITURE
    - OTHER FURNITURE FOR PUBLIC FACILITIES
  - **SPECIAL FURNITURE**
    - PERIOD FURNITURE
    - BAMBOO, RATTAN AND EXOTIC FURNITURE
    - GARDEN FURNITURE
  - **INTERIOR DECORATION**
    - INTERIOR DESIGN AND FITTING CUSTOM-MADE FURNITURE
    - FLOORING AND WALL COVERINGS
      - Carpets and textile flooring
      - Parquet, matched floor, laminate flooring
      - Wall coverings
    - LIGHTING
    - BUILT-IN FURNITURE
      - Doors
      - Windows
      - Staircases
      - Partition elements, closets
      - Blinds, shutters, awnings
      - Fire-places, stoves
    - ACCESSORIES AND FURNISHING FABRICS
      - Curtains and draperies
      - Haberdashery and furnishing fabrics
      - Mirrors, picture frames, battens and other decorative items
      - Other decorative items
  - **PRODUCTION MATERIALS**
    -
  - **OTHER**
    - TECHNICAL LITERATURE
    - 
    - Other \_\_\_\_\_

TO BE FILLED IN BY BELGRADE FAIR

Confirmed acceptance of Application form

File No. \_\_\_\_\_

Venue and date

Seal

Exhibitors signature

Location

Date-  
Signature-Seal



**BELGRADE  
FAIR**

DESIGN SECTION

Bulevar vojvode Misica 14, 11000 Beograd, Serbia

Tel: +381 11 2655 225

Fax: +381 11 2655 522

arh@sajam.rs

sajamnamestaja.rs

59<sup>th</sup>

**International Fair  
of Furniture, Equipment  
and Interior Decoration**

**October 6-11, 2023**

59<sup>th</sup>

**Belgrade  
Furniture  
Fair 2023  
Now**



**3**

**Application Form  
Full Package Stand Type STANDARD**

To be filled in block letters

Full name of Exhibitor:	
Address: country, town Street and number, P.O.B.:	
Phone:	Tel/Mob:
E-mail:	http:
Agent in Serbia (name, address & phone):	
All correspondence to be addressed to:	All contacts should be made through:

**Standard aluminium construction**

I order herewith the construction and full service arrangement of the exhibition space of:	12-24 sq.m.	25-38 sq.m.	39-60 sq.m.
<input type="text"/> sq.m. <b>28 € /sq.m.</b>			
<b>Services and equipment included in price/sq.m:</b>			
Partition walls	✓	✓	✓
Name panel - logo	✓	✓	✓
Instant use carpet - grey	✓	✓	✓
Info desk/podium	1/0	1/1	2/2
Table/Chairs	1/4	1/6	2/8
Bar stool	/	1	1
Cubicle incl. curtain	/	✓	✓
Spot light 100W	4	6	8
Lockable cupboard	1	1	1
Socket up to 1kW	1	1	1
Decorative arrangement of exhibits	✓	✓	✓
Space fee	✓	✓	✓

**Notice: It is necessary to apply your logo by e-mail: arh@sajam.rs (.ai, .pdf, .eps format)**

**We have booked a full package stand and order the following additional equipment according to the condition overleaf: (please tick)**

	Pcs.	€ /Pcs.		Pcs.	€ /Pcs.		Pcs.	€ /Pcs.
<input type="checkbox"/> Door with a lock	<input type="text"/>	25,-	<input type="checkbox"/> LCD TV 55"/65"	<input type="text"/>	150,-	<input type="checkbox"/> Company logo 96x62, adv. tower	<input type="text"/>	30,-
<input type="checkbox"/> Info desk 100/200x50x105	<input type="text"/>	80,-	<input type="checkbox"/> Glass Showcase 100x100x220	<input type="text"/>	80,-	<input type="checkbox"/> Company logo 196x62, adv. tower	<input type="text"/>	50,-
<input type="checkbox"/> Table	<input type="text"/>	10,-	<input type="checkbox"/> Glass Showcase 100x50x220	<input type="text"/>	60,-	<input type="checkbox"/> Company logo fascia 186x22	<input type="text"/>	30,-
<input type="checkbox"/> Chair	<input type="text"/>	10,-	<input type="checkbox"/> Glass Showcase 50x50x220	<input type="text"/>	40,-	<input type="checkbox"/> Digital print mesh, vinyl / self-adhesive foil	<input type="text"/>	18-21,- /sq.m.
<input type="checkbox"/> Bar stool	<input type="text"/>	20,-	<input type="checkbox"/> Low Glass Showcase 100/50x75	<input type="text"/>	30/40,-	<input type="checkbox"/> Laminate floor	<input type="text"/>	15-30,- /sq.m.
<input type="checkbox"/> Podium	<input type="text"/>	30,-	<input type="checkbox"/> Advertising Tower Structure	<input type="text"/>	50,-	<input type="checkbox"/> _____	<input type="text"/>	_____

**The prices are mentioned in NET amounts. VAT shall be added to them.**

I state herewith that I am cognizant with Belgrade Fair price list,

Terms for construction and arrangement of exhibition space which I fully accept.

Stand construction cancellation costs shall be invoiced to the amount of 50% of the stand construction price.

Venue and date

Seal

Signature

TO BE FILLED IN BY BELGRADE FAIR

Confirmed acceptance of Application form

sq.m.

Date, signature and seal

**3a**
**Application Form  
Full Package Stand Type LUX**

To be filled in block letters

<b>Full name of Exhibitor:</b>	
<b>Address: country, town Street and number, P.O.B.:</b>	
<b>Phone:</b>	<b>Tel/Mob:</b>
<b>E-mail:</b>	<b>http:</b>
<b>Agent in Serbia (name, address &amp; phone):</b>	
<b>All correspondence to be addressed to:</b>	<b>All contacts should be made through:</b>

**Syma Molto aluminium construction (cubical structures)**

I order herewith the construction and full service arrangement of the exhibition space of:

12-24 sq.m.

25-38 sq.m.

39-60 sq.m.

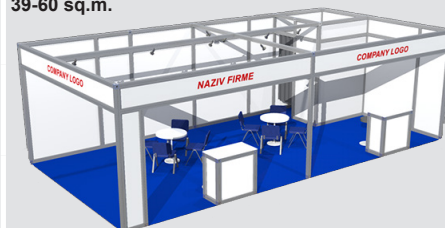
 sq.m. **40 € /sq.m.**

**Services and equipment  
included in price/sq.m:**

	12-24 sq.m.	25-38 sq.m.	39-60 sq.m.
Partition walls	✓	✓	✓
Name panel - logo	✓	✓	✓
Instant use carpet - grey	✓	✓	✓
Info desk/podium	1/0	1/1	2/2
Table/Chairs	1/4	1/6	2/8
Bar stool	/	1	1
Cubicle incl. curtain	/	✓	✓
Spot light 100W	4	6	8
Lockable cupboard	1	1	1
Socket up to 1kW	1	1	1
Decorative arrangement of exhibits	✓	✓	✓
Space fee	✓	✓	✓

**Notice: It is necessary to apply your logo by e-mail: arh@sajam.rs (.ai, .pdf, .eps format)**
**We have booked a full package stand and order the following additional equipment according to the condition overleaf: (please tick)**

	Pcs.	€/Pcs.		Pcs.	€/Pcs.		Pcs.	€/Pcs.
<input type="checkbox"/> Door with a lock	<input type="text"/>	45,-	<input type="checkbox"/> LCD TV 55"/65"	<input type="text"/>	150,-	<input type="checkbox"/> Company logo 91x91, adv. tower	<input type="text"/>	30,-
<input type="checkbox"/> Info desk 100/200x50x110	<input type="text"/>	110,-	<input type="checkbox"/> Glass Showcase 100x100x220	<input type="text"/>	80,-	<input type="checkbox"/> Company logo 191x91, adv. tower	<input type="text"/>	50,-
<input type="checkbox"/> Table	<input type="text"/>	20,-	<input type="checkbox"/> Glass Showcase 100x50x220	<input type="text"/>	60,-	<input type="checkbox"/> Company logo fascia 191x41	<input type="text"/>	40,-
<input type="checkbox"/> Chair	<input type="text"/>	20,-	<input type="checkbox"/> Glass Showcase 50x50x220	<input type="text"/>	40,-	<input type="checkbox"/> Digital print mesh, vinyl / self-adhesive foil	<input type="text"/>	18-21,- /sq.m.
<input type="checkbox"/> Bar stool	<input type="text"/>	30,-	<input type="checkbox"/> Low Glass Showcase 100/50x100	<input type="text"/>	30/40,-	<input type="checkbox"/> Laminate floor	<input type="text"/>	15-30,- /sq.m.
<input type="checkbox"/> Podium	<input type="text"/>	40,-	<input type="checkbox"/> Advertising Tower Structure	<input type="text"/>	70,-	<input type="checkbox"/>	<input type="text"/>	

**The prices are mentioned in NET amounts. VAT shall be added to them.**

 I state herewith that I am cognizant with Belgrade Fair price list,  
 Terms for construction and arrangement of exhibition space which I fully accept.  
 Stand construction cancellation costs shall be invoiced to the amount of 50% of the stand construction price.

 Venue and date       Seal       Signature

TO BE FILLED IN BY BELGRADE FAIR

 Confirmed acceptance of Application form  sq.m.

 Date, signature and seal



**BELGRADE  
FAIR**

DESIGN SECTION

Bulevar Vojvode Misica 14, 11000 Belgrade, Serbia

Tel: +381 11 2655 225

Fax: +381 11 2655 522

arh@sajam.rs

sajamnamestaja.rs

59<sup>th</sup>

**International Fair  
of Furniture, Equipment  
and Interior Decoration**

**October 6-11, 2023**

59<sup>th</sup>

**Belgrade  
Furniture  
Fair 2023  
Now**



**3b**

**Application Form - Custom made Individual Stand**

To be filled in block letters

Full name of Exhibitor:

Address: country, town

Street and number, P.O.B.

Phone:

Tel/Mob:

E-mail:

http:

Agent in Serbia  
(name, address & phone):

All correspondencies to be addressed to:

All contact should be made through:

Payment affected to the bank account number:

**I ORDER HEREWITH THE CONSTRUCTION AND FULL SERVICE ARRANGEMENT:**

**ACCORDING TO DESIGN PROPOSAL AND PRICE INCLUDED**

sq.m.

**The prices are mentioned in NET amounts. VAT shall be added to them.**

I state herewith that I am cognizant with Belgrade Fair price list,  
Terms for construction and arrangement of exhibition space which I fully accept.  
Stand construction cancellation costs shall be invoiced to the amount of 50% of the stand  
construction price.

TO BE FILLED IN BY BELGRADE FAIR

Confirmed acceptance  
of Application form

sq.m.

Date, signature and seal

Venue and date

Seal

Signature



# 4

## Application Form for Technical Services

To be filled in block letters

**Full name of Exhibitor:**
**Address: country, town  
Street and number, P.O.B.:**
**Contact person:**
**Tel:**
**Mob.phone:**
**E-mail:**

### Technical services

	Pcs.	€/Pcs.		Pcs.	€/Pcs.
<input type="checkbox"/> Club table	<input type="text"/>	10,-	<input type="checkbox"/> Coffee machine with 96 capsules / additional 96 Capsules	<input type="text"/> / <input type="text"/>	100/90,-
<input type="checkbox"/> Chair	<input type="text"/>	10,-	<input type="checkbox"/> Refrigerator	<input type="text"/>	90,-
<input type="checkbox"/> Rack	<input type="text"/>	10,-	<input type="checkbox"/> Connection with/without sink	<input type="text"/>	70,-
<input type="checkbox"/> Carpet	<input type="text"/>	10,-	<input type="checkbox"/> Additional connection at the booth	<input type="text"/>	30,-
<input type="checkbox"/> LCD TV 55"/65"	<input type="text"/>	200,-	<input type="checkbox"/> Flow boiler	<input type="text"/>	25,-
<input type="checkbox"/> Telephone	<input type="text"/>	30,-	<input type="checkbox"/> Connection with a mini kitchen	<input type="text"/>	130,-
<input type="checkbox"/> Stand safeguarding 7,-/1h			<input type="checkbox"/> Connection with a mini kitchen and a hot plate	<input type="text"/>	150,-
<input type="checkbox"/> Vacuum cleaning / floor wiping 7,-/1h			<input type="checkbox"/> Compulsory fee for the mutual costs		4,50/sq.m

 Switchboard\*  50,-

\* The switchboard shall be used to connect electric power to the stand

### Electric connection for stand equipping and exhibit demonstration

### Electric connection for special lighting

	Pcs.	€/Pcs.		Pcs.	€/Pcs.
<input type="checkbox"/> total power up to 5 kW	<input type="text"/>	86,-	<input type="checkbox"/> total power up to 5 kW	<input type="text"/>	110,50
<input type="checkbox"/> total power up to 10 kW	<input type="text"/>	125,-	<input type="checkbox"/> total power up to 10 kW	<input type="text"/>	177,-
<input type="checkbox"/> total power up to 20 kW	<input type="text"/>	207,-	<input type="checkbox"/> total power up to 20 kW	<input type="text"/>	304,-

\* The prices of power connection higher than 20 kW, as well as the connection prices for the events taking more than 10 days, will be specified as demanded, by special price offers and decisions.

### Internet connection for exhibitors

	Pcs.	€/Pcs.		Pcs.	€/Pcs.
<input type="checkbox"/> WiFi (up to 5/5 Mb/s)	<input type="text"/>	50,-	<input type="checkbox"/> LAN (up to 50/50 Mb/s)	<input type="text"/>	250,-

### ADDITIONAL SERVICES

<input type="checkbox"/> Device additional configuration, network spreading and other technician services	30,-/h	<input type="checkbox"/> The materials spent for the additional services (cables, connectors, etc.)	market value
---	--------	---	--------------

### Special request

(Write in special requests referring to the services indicated above)

 Belgrade Fair reserves the right to correct the prices.  
 Payment upon receipt of invoice. The prices are mentioned in NET amounts. VAT shall be added to them.

Venue and date

Seal

Exhibitors signature

The services mentioned in the Technical Service Price List can be contracted solely in the Inspection Office of the relevant exhibiting hall, where also information on other services that can be rendered by Belgrade Fair can be obtained respectively. The afore mentioned services are not included in the exhibiting space rental or construction price and they are subject to additional payment.

#### **ELECTRICITY**

Belgrade Fair power has got the voltage of 220 V single phase and 3 x 380 V three phase alternating power of 50 Hz. Any cables and/or devices shall be compatible for operation under the said voltage and frequency. For manufacturing of cabling for connection of various devices, machines, and lights, as for protection from the touch-voltage, regulations on manufacturing of temporary electrical cables shall be applied accordingly. A stand shall have a switchboard, fully in accordance with the regulations, Belgrade Fair will connect it to the network. The connection of the installed cables shall be approved by an authorized employee of Belgrade Fair Electricity Department.

#### **TELEPHONE**

Belgrade Fair has got an internal mail telephone exchange for its users, which enables all kind of incoming and outgoing telephone calls automatically (an operator calling for the connection is necessary). The connection means a connection to the telephone network with a telephone set, whereas usage of an additional set or fax machine is subject to additional payment in accordance with the price list.

#### **WATER**

Belgrade Fair plumbing has got the connection size 3/4 inch, which can be reset to 1/2 inch upon request. Any water connection made by an exhibitor shall be approved by Belgrade Fair authorized staff.

#### **INTERNET**

1. The exhibitor MAY NOT install and use its own WiFi devices, emitting signals at his booth at 2.4 GHz and 5 GHz. If he however installs them and they disturb work of other WiFi users, Belgrade Fair shall be entitled to turn such devices off or stop supplying electric power to the booth until the device has been removed (all exhibitors are recommended to use Belgrade Fair WiFi infrastructure of the latest generation, in order to avoid the possibility of disturbances at the WiFi frequencies).
2. Belgrade Fair does not guarantee the speeds through the WiFi connections, since they depend upon many factors (WiFi card quality in the device, obstacles and distance from AP, the drivers in the devices, etc.).
3. The cable package shall be fulfilled where the relevant technical possibilities exist and shall be announced not later than seven days before the event opening.
4. The cable package price DOES NOT include the costs of network spreading and configuration at the exhibitor's booth.
5. The connection speeds and special requirements, which differ from those already offered shall be contracted separately, not later than seven days before the event opening.

#### **STAFF ENGAGEMENT**

Subject to filling in the relevant form and additional payment in accordance with the Price List, Belgrade Fair puts to its exhibitors disposal staff for all types of works mentioned therein.

#### **FURNITURE AND EQUIPMENT:**

Belgrade Fair rents furniture and other necessary equipment for the exhibiting space arrangement, in accordance with Belgrade Fair Price List prices.

The furniture and equipment rent price includes furniture rent for one fair event and the costs of the furniture delivery to the stand and its removal from it.

#### **COMPULSORY FEE FOR THE MUTUAL COSTS:**

The Exhibitors constructing their stands themselves shall pay the compulsory fee for mutual costs according to the rented exhibiting space, as follows:

- 0 - 150 sq. m. - each square meter shall be calculated
- 151 - 300 sq. m. - fixed 150 sq. m. + 40% difference between 300 and 150 sq. m.
- 301 - 500 sq. m. - fixed 210 sq. m. + 30% difference between 500 and 300 sq. m.
- More than 500 sq. m. - fixed 270 sq. m. + 20% difference between the actual space and 500 sq. m.

#### **EXHIBIT INSURANCE**

Exhibits and any other Exhibitor's property shall be insured against theft, damage, etc. at all fair events taking place at Belgrade Fair. The insurance of exhibits and any other Exhibitor's property shall cover the time period from the good unloading at Belgrade Fair, mounting, the event duration, dismantle, up to the goods loading into a transportation vehicle while leaving Belgrade Fair premises. The Exhibitor may insure his goods through an insurance company in this country or abroad. Should the exhibits or any other Exhibitor's property not be insured in one of the ways mentioned, the Exhibitor shall be fully responsible for any damage to such exhibits or other property.

#### **INFO**

##### **Hall 1**

Tel: +381 11 2655 191, 2655 190  
Fax: +381 11 2655 191

##### **Hall 2 and 1A**

Tel: +381 11 2655 241, 2655 240  
Fax: +381 11 2655 241

##### **Hall 3 and 3A**

Tel: +381 11 2655 341, 2655 340  
Fax: +381 11 2655 341

##### **Hall 4**

Tel: +381 11 2655 848, 2655 014  
Fax: +381 11 2655 848

##### **Hall 5, Hall 11 and Open area**

Tel: +381 11 2655 261, 2655 260  
Fax: +381 11 2655 260

E-mail: [inspektori@sajam.rs](mailto:inspektori@sajam.rs)

# 5 Application Form for Advertising Services

The present Application form should be filled in and certified in two copies. All copies should be submitted to Belgrade Fair which will confirm the receipt and return a copy to the Exhibitor.

To be filled in block letters

Full name of Exhibitor:		Contact person:	Mob.phone:
Address: country, town Street and number, P.O.B.:		Mail:	
Tel/Fax:		E-mail:	
Payment affected to:		The Bank Acc. no.:	VAT number:

## Advertising space - printed



Megaboard, Underground Passage,  
995x195 cm, paper, illuminated **490 €/piece** pcs.



Billboard  
300x200 cm, paper **225 €/piece** pcs.



Double sided billboard on the  
pedestrian bridge, 95x195 cm, paper **99 €/piece** pcs.



Colonnade in front of the Hall 2  
vinyl 8x1 m, incl. 4 billboards, 95x195 cm **550 €/piece** pcs.

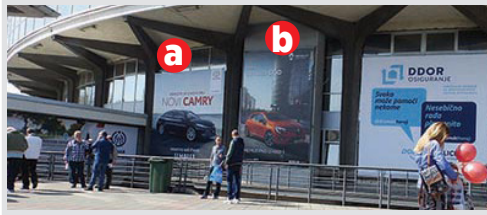

a) Megaboard on  
Hall 1, 6x6, vinyl pcs.   
**1.500 €/piece**

b) Megaboard on  
Hall 1, 4x6, paper pcs.   
**600 €/piece**



Megaboard at Hall 1, V-banner,  
vinyl, 735x427 cm **960 €/piece** pcs.



a) Billboard  
6x1.5m pcs.   
**160 €/piece**

b) Vinyl on railing  
above the stand sq.m   
**30 €/sq.m**



Advertising surface  
on the vinyl per sq.m. **30 €/sq.m** sq.m



Flag pole (height 11m) at the Boulevard  
for brought flags up to 140x500 cm **100 €/piece** pcs.

## Advertising space in the Exhibitor Registry

- 2<sup>nd</sup> cover **270 €**  Advertising page **200 €**  
 3<sup>rd</sup> cover  
 4<sup>th</sup> cover

## Advertising document distribution within the fairground\* (price per 1 day)

- Adv. doc. distribution FOR EXHIBITORS **100 €**  Adv. doc. distribution **200 €**

\*distribution is carried out by the client

**PLEASE FIND THE COMPLETE ADVERTISING LIST ON OUR WEBSITE**

### Note:

The prices are mentioned in NET amounts. VAT shall be added to them.  
Payment upon receipt of proforma invoice.

TO BE FILLED IN BY BELGRADE FAIR

Confirmed acceptance  
of Application form

Hall No.

Location

Venue and date

Seal

Exhibitors signature

Date, signature and seal

Please send the prepress files, including the filled-in and sealed application, to the e-mail address [in.ad@sajam.rs](mailto:in.ad@sajam.rs), not later than twenty days before the event opening.

Please upload larger files (10 MB and more) to some file sharing service (i.e. WeTransfer) and place the link in the email.

The Advertising Department shall reserve an adequate space for you, as well as a different advertising component, if the requested space has already been rented, in accordance with the available space and the dates of the application, as well as its receipt of documents.

The rent price of all advertising components shall be related to the duration period of each fair event, other than the items otherwise defined (rented on a day or monthly basis).

The Fair shall control the advertising components during the fair events. In case of any damage of such components, the Fair shall replace them as soon as possible, at its own cost.

Any specific orders shall be contracted personally (facade or window graphics, megaboard, rent of the advertising balloons, distribution of advertising materials along with entry tickets, etc).

Any installation of advertising towers, fascias, columns or wall panels exceeding the height of 3 meters shall be subject to the approval of the Advertising Department and the Design Office.

The flag poles and flags shall not be installed independently outside the rented advertising space.

Any advertising components individually installed by an exhibitor on the Fair ground (banners, flags, rigid components, etc.) shall be charged by the valid prices from the present price list. Belgrade Fair reserves its right to remove the afore mentioned components if they esthetically spoil the event general look or another exhibitor's component, as estimated by Belgrade Fair.

## File prepress

The printing files shall be sent in Adobe Photoshop **EPS** or Adobe Illustrator **EPS** or **PDF** format.

### Adobe Photoshop:

File scale for large print formats (i.e. billboard 4m x 3m) - 1:10.  
Resolution 300-500 dpi.

File scale for small print formats (i.e. B2 poster) - 1:1.  
Resolution 100-150 dpi.

Colour mode: **CMYK**

File recording: Photoshop Encapsulated Postscript (**EPS**), with the following settings:

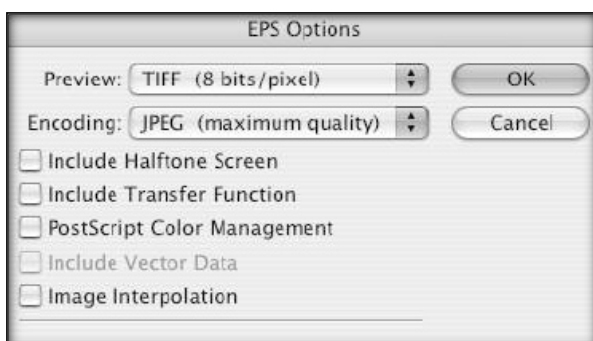

### Adobe Illustrator:

File scale for large print formats - 1:10.

File scale for small print formats - 1:1.

The file **SHOULD NOT** include any wedges, passers, clips, printing instructions, measures, numbers of copies, etc.

Each file is a print itself (if you have five posters, you should record them in five different files).  
Convert the text into curves.

Colour mode: **CMYK**

File recording : **EPS** or **PDF**.

If the prepress is a combination of vector and raster elements, please merge and export it as a single raster. Make sure that you send a proof with the files. We can not accept CorelDraw files.

**Please make the files in accordance with the above mentioned instructions. Otherwise, BELGRADE FAIR shall not be responsible for the printing quality!**

# 5a Application for Advertising Services in the Furniture Fair Guide

To be filled in block letters

Full name of Exhibitor:

 Address: country, town  
 Street and number, P.O.B.:

Phone:







Fax:

E-mail:

http:

Agent in Serbia (name, address &amp; phone):

Contact person:

Advertising services	€	Dimensions	File dimensions
<input type="checkbox"/> The second cover 	480,-	171 x 225 mm	181 x 235 mm
<input type="checkbox"/> The third cover 	480,-	171 x 225 mm	181 x 235 mm
<input type="checkbox"/> The fourth cover 	480,-	171 x 225 mm	181 x 235 mm
<input type="checkbox"/> The medium / double page 	720,-	342 x 225 mm	352 x 235 mm
<input type="checkbox"/> Advertising page 	360,-	171 x 225 mm	181 x 235 mm
<input type="checkbox"/> 1/2 of the advertising page 	200,-	86 x 225 mm	96 x 235 mm
<input type="checkbox"/> 1/4 of the advertising page 	150,-	86 x 113 mm	96 x 123 mm

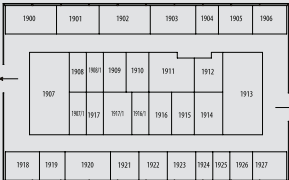

<input type="checkbox"/> A mark on the hall plan	100,-	 <p>25 mm width. The height according to the width.</p>
--	-------	--

All above mentioned prices are net amounts. VAT shall be added to each of the prices accordingly.

All advertisements are in colors. The prepressed files shall be in .eps, .tiff, .ai or .pdf format. The fonts need to be replaced by curves. All photos shall be in CMYK color profile, 300 dpi resolution. The logo shall be submitted in the vector format.

Venue and date

Seal

Exhibitors signature

TO BE FILLED IN BY BELGRADE FAIR

 Name of exhibition and  
hall number



**BELGRADE  
FAIR**

**RENTAL SERVICES**

Bulevar vojvode Misica 14, 11000 Beograd, Srbija  
Tel/Fax: +381 11 2655 809  
jovica.dimitrijevic@sajam.rs  
sajamnamestaja.rs

59<sup>th</sup>

**International Fair  
of Furniture, Equipment  
and Interior Decoration**

**October 6-11, 2023**

59<sup>th</sup>

**Belgrade  
Furniture  
Fair 2023  
Now**



# 6 Application Form for Participation in the Side Event Programs

To be filled in block letters

Full name of Exhibitor:		
Address: country, town:		
Street and number, P.O.B.:		
Phone:	Fax:	
E-mail:	http:	
Agent in Serbia (name, address & phone):		
Contact person:	Mob.phone:	Mail:
Payment affected to:	The Bank Acc. no.:	
VAT number:		

Conference rooms rent	Date	Time of use	€/h
Large Conference hall in the exhibiting Hall 4, with sound system and equipment, the price per started hour (capacity 300 seats)			250,-
Small Conference hall in the exhibiting Hall 4, with sound system and equipment, the price per started hour (capacity 50 seats)			150,-
Festive Hall in the Head office, with sound system and equipment, the price per started hour (capacity 150 seats)			250,-

For the presentation we need: (please tick)     Screen     LCD Projector for PC Presentations     PC Laptop     Internet

The prices are mentioned in NET amounts. The amount of the invoice will be increased by the legal VAT rate.  
Payment upon receipt of the proforma-invoice

TO BE FILLED IN BY BELGRADE FAIR

Venue and date	Seal	Exhibitors signature	Date, signature and seal	Reservation confirmation
				Time to